

## BLACKline Torch sets MS/MG/MC 340C SA

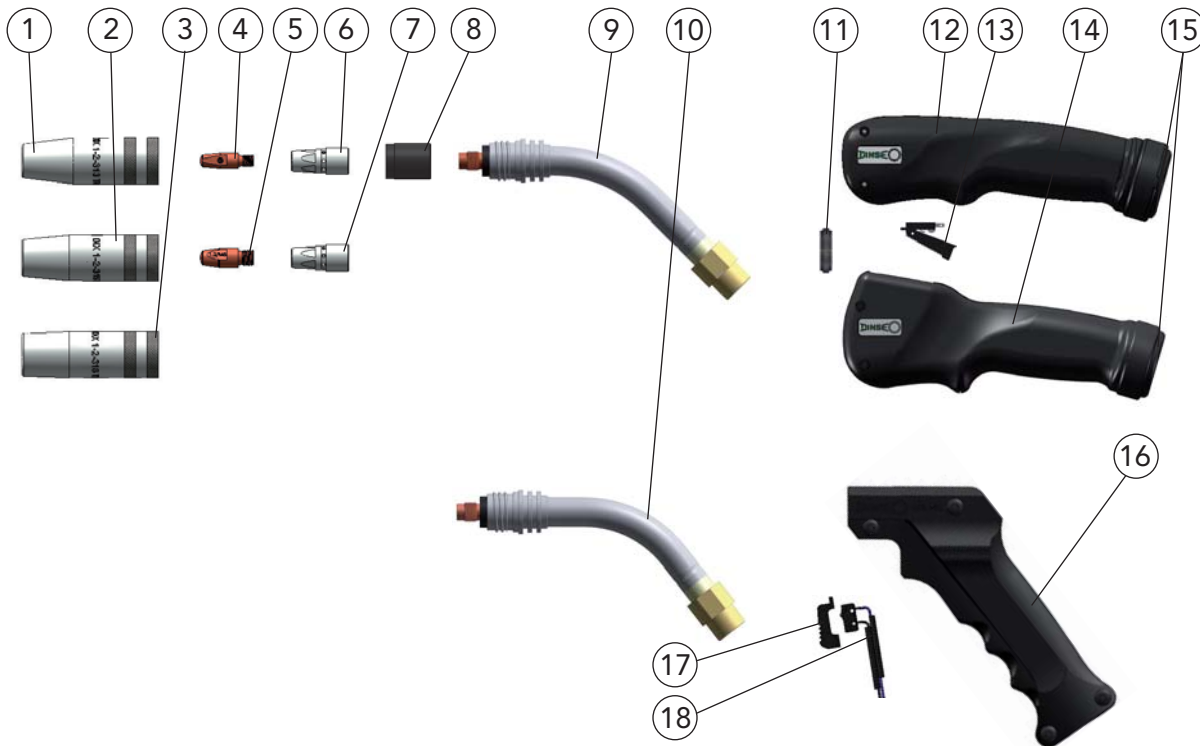

Description	Dimension	Part name	Part number
1 Gas nozzle	ø 13 mm	DIX 1-2-313 TR	6290103130
2 Gas nozzle	ø 15 mm	DIX 1-2-315 TR	6290103150
3 Gas nozzle	ø 18 mm	DIX 1-2-318 TR	6290103180
4 Contact tip	M6 x 28 mm	DIX 3-2-__	6290300__
Contact tip	M6 x 28 mm	DIX 3-2-__ CR-ZR	6290330__
5 Contact tip	M8 x 28 mm	DIX 3-2-__ M8	6290301__
Contact tip	M8 x 28 mm	DIX 3-2-__ M8 CR-ZR	6290331__
6 Tip adapter	M6	DIX GS 300 M6	629040301
7 Tip adapter	M8	DIX GS 300 M8	629040302
8 Insulating sleeve		DIX IH 340	629060341038
9 Torch neck	45°	DIX 6-2-340 C 45°	6290603414
10 Torch neck	52°	DIX 6-2-340 C 52°	6290603410
11 Support ring		DIX H SR 340	629071030
Cap, without picture		DIX H C	629071014
12 Housing, with pos. 13		DIX HS 1	629071000
13 Switch		DIX S1	629071022
14 Housing, with pos. 13		DIX HC 1	629071001
15 Fixing ring		DIX 12-3-510 HR	6391250013
Fillet blind, H/C, without picture			629071016
16 Housing		DIX HG 1	629071018
17 Trigger		DIX 9-2	629090000
18 Microswitch		DIX 8-2 CG	629080001

\_\_ Enter the required wire diameter, e.g.: 10 = 1.0 mm or 12 = 1.2 mm.

- Standard equipment for wire diameter 1.0 mm steel with gas nozzle DIX 1-2-313 TR, contact tip DIX 3-2-1.0 M6, tip adapter DIX GS 300 M6 and liner DIX DSC 4.5/2,2. Variants deviating of the standard fittings on request.

**BLACKline Torch sets MS/MG/MC 340C SA**  
**Basic torch set MX 300C SA**

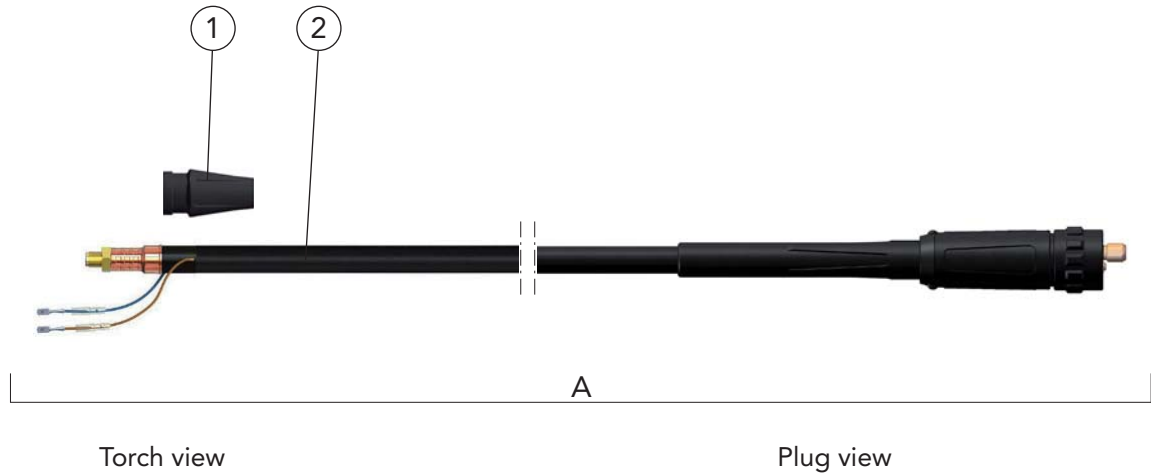

**●** Also available with Power pin connection. You will find the suitable power pin set coaxial for you wire feeder in the chapter tools and accessories. Please ask your DINSE consultant.

Description	Dimension	Part name	Part number
A Basic torch set		DIX MX 300C-__ SA	62021310-__
1 Bend protection	50 qmm	DIX BPC 50	629071017
2 Coaxial cable	3.0 m	DIX VLM 300C-3	629203430
Coaxial cable	4.0 m	DIX VLM 300C-4	629203440

-- Enter the required length of the basic torch set, e.g.: 31 = 3.0 m or 41 = 4.0 m.  
 Standard length: 3.0 m and 4.0 m